

செ. பெ. வ. கு. (பி)
ந. எண் 161/27/28/06
உதவி வரைபாளர்
கி. உ. சி. சி. சி.
உ. தி. அ. 3/3

திருத்திய வரைபாளர்
நாள் 20.12.2006

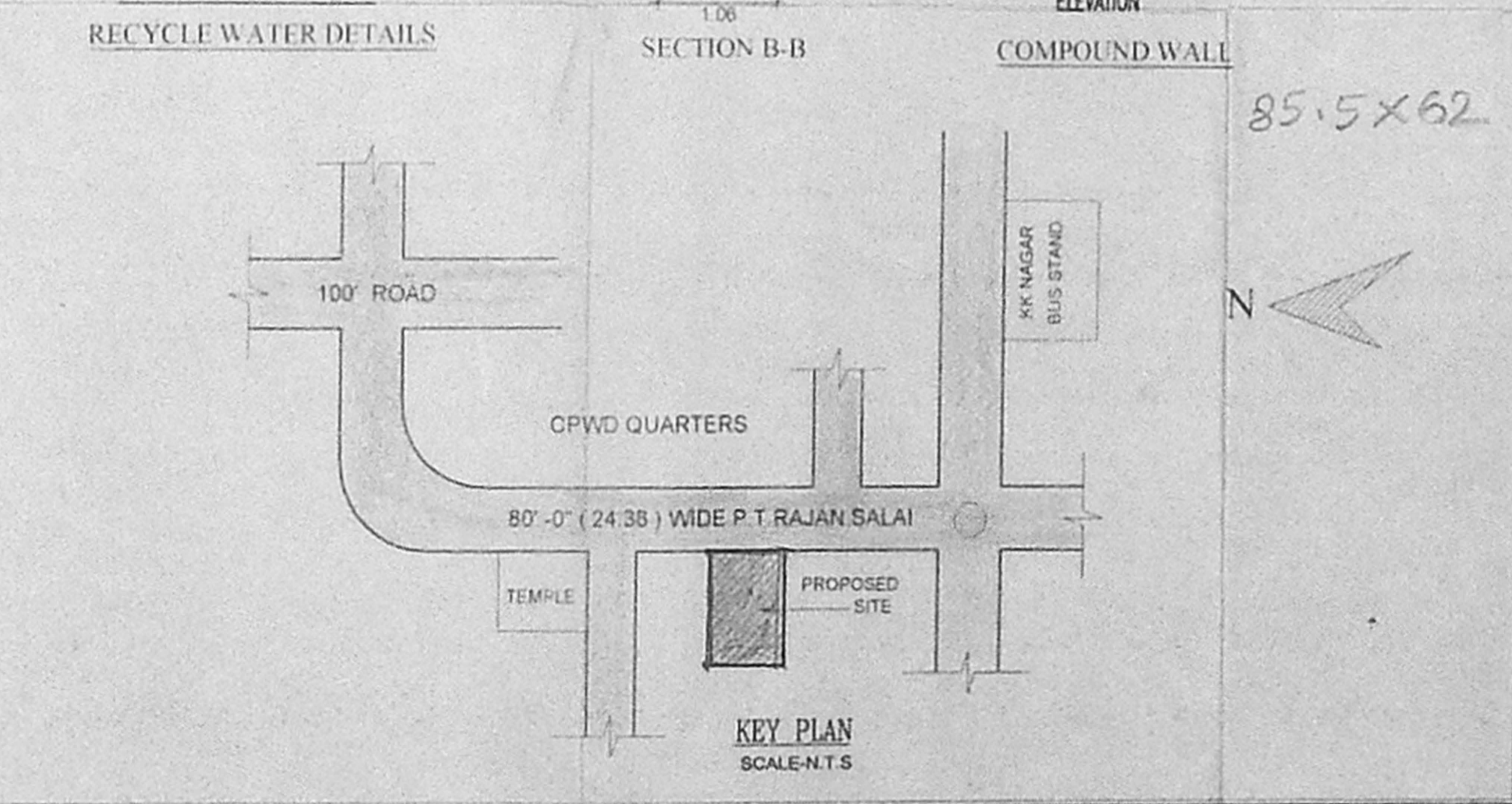
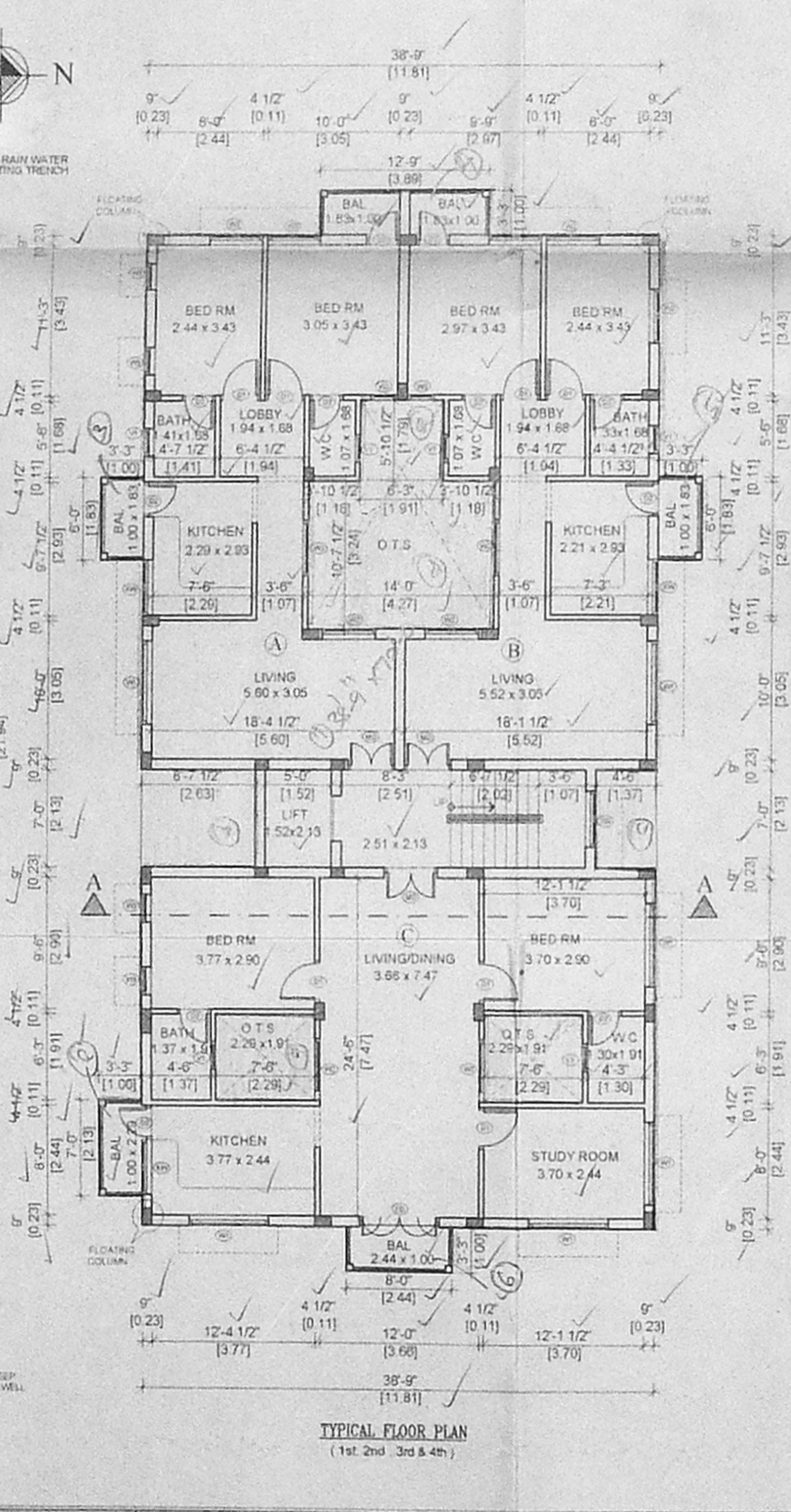
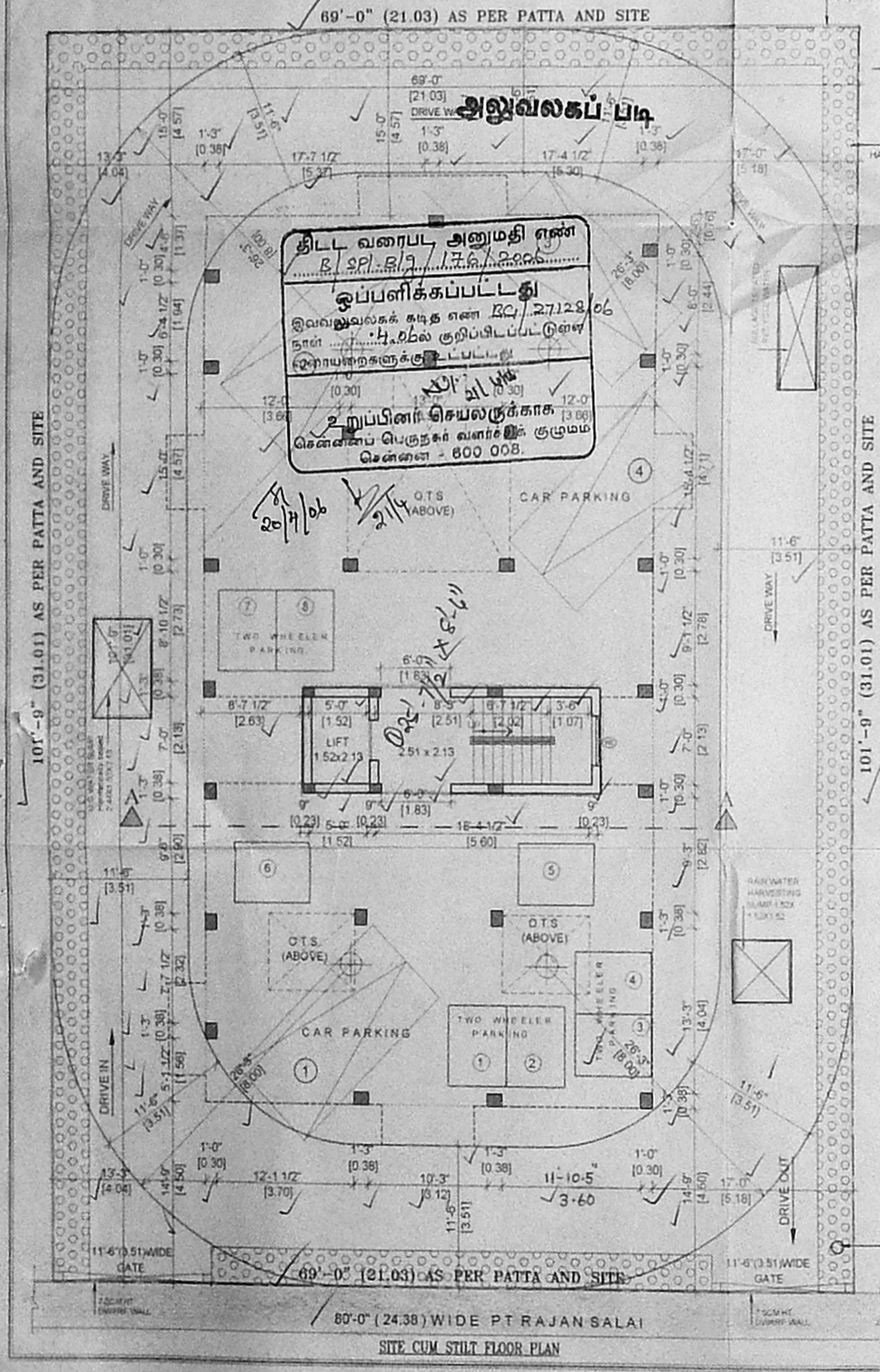
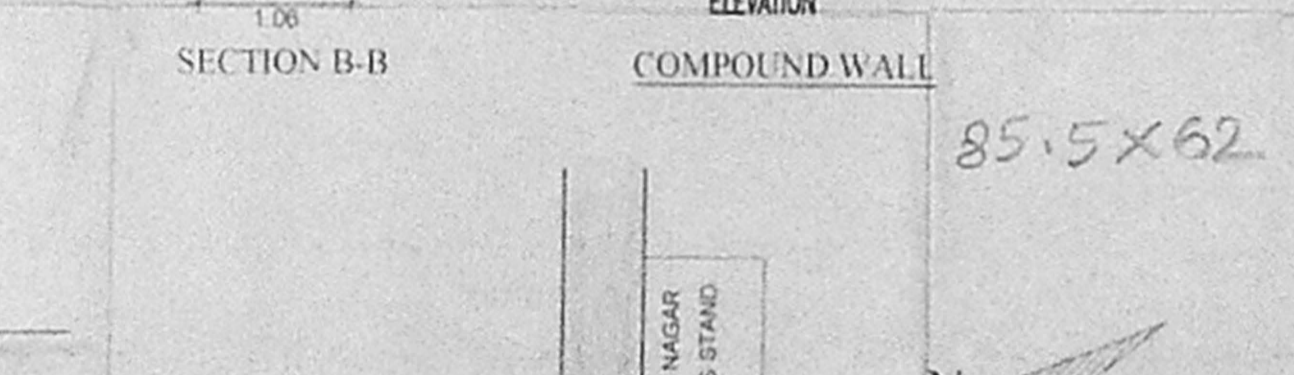
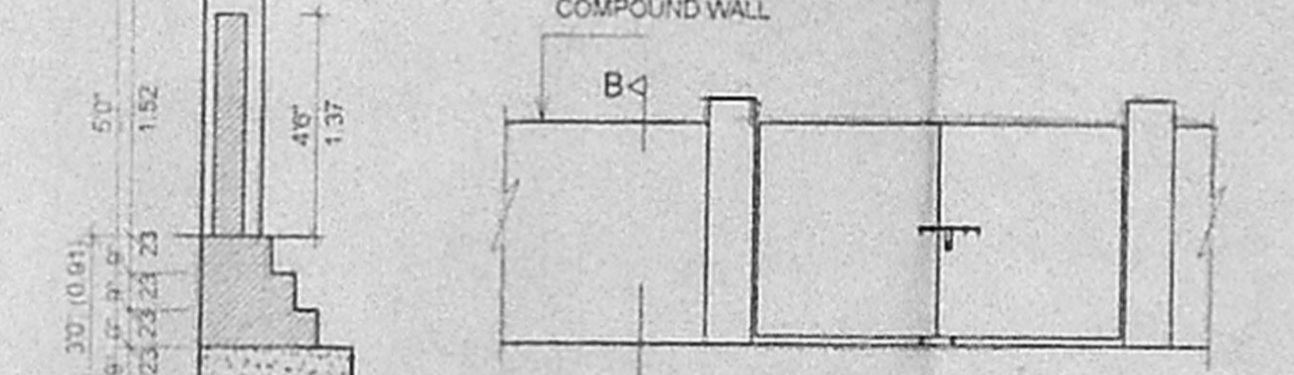
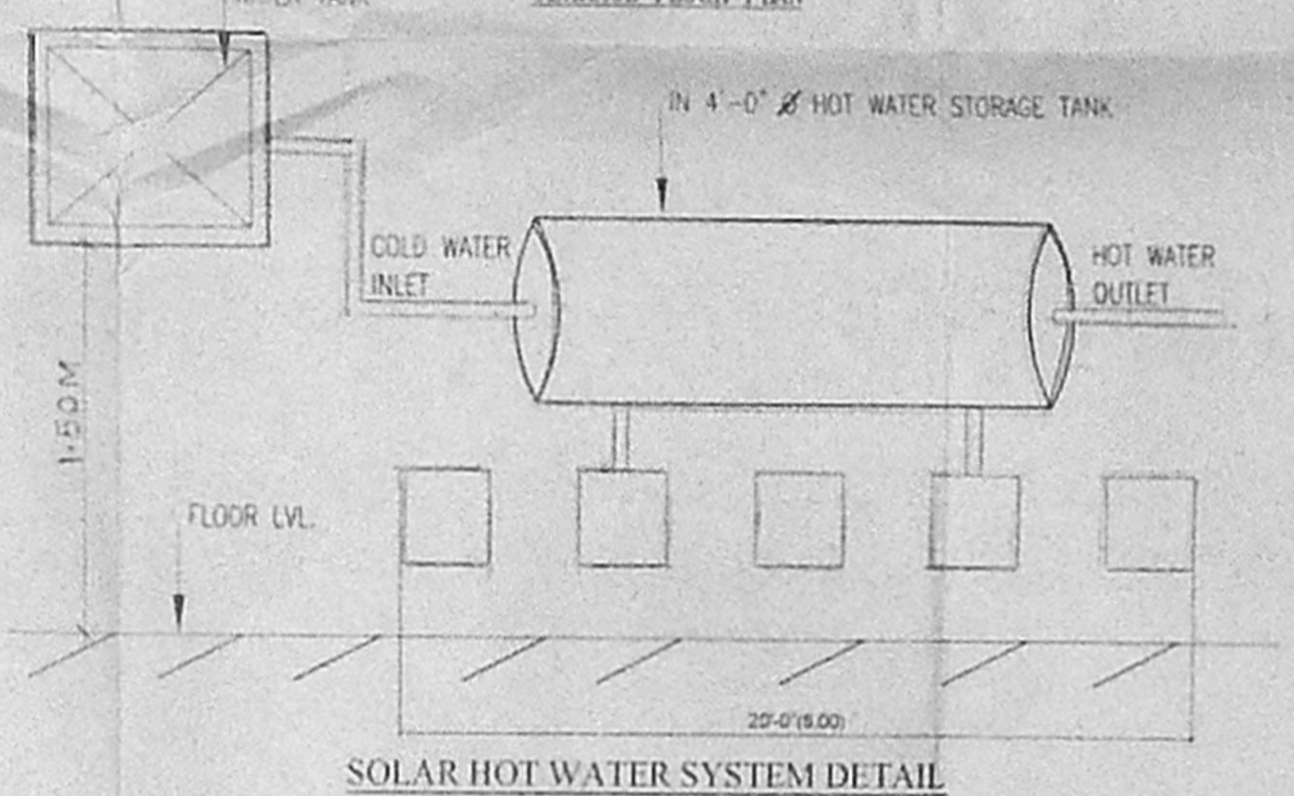
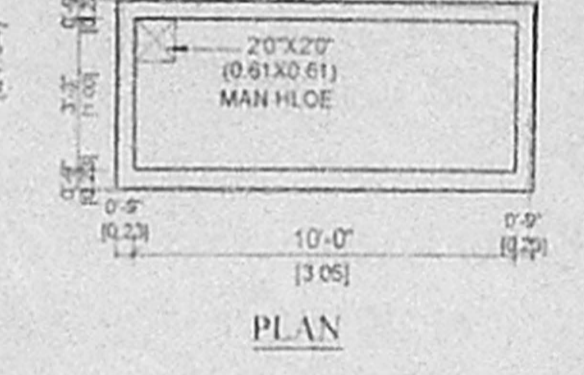
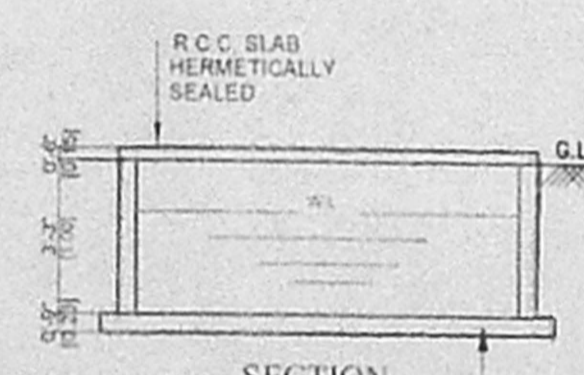
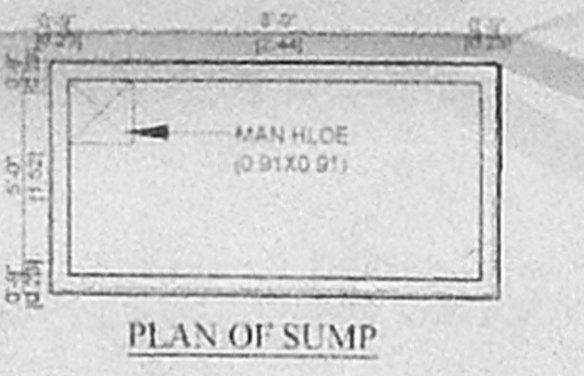
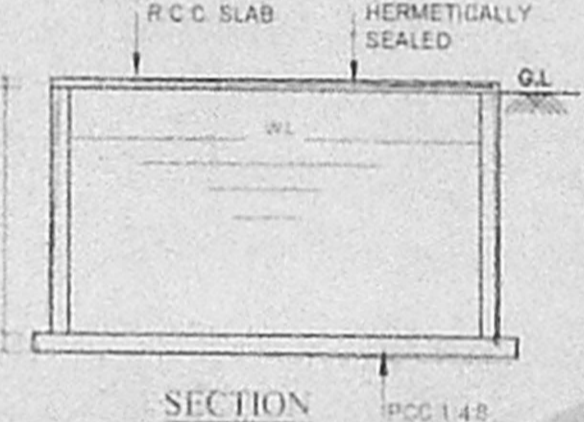
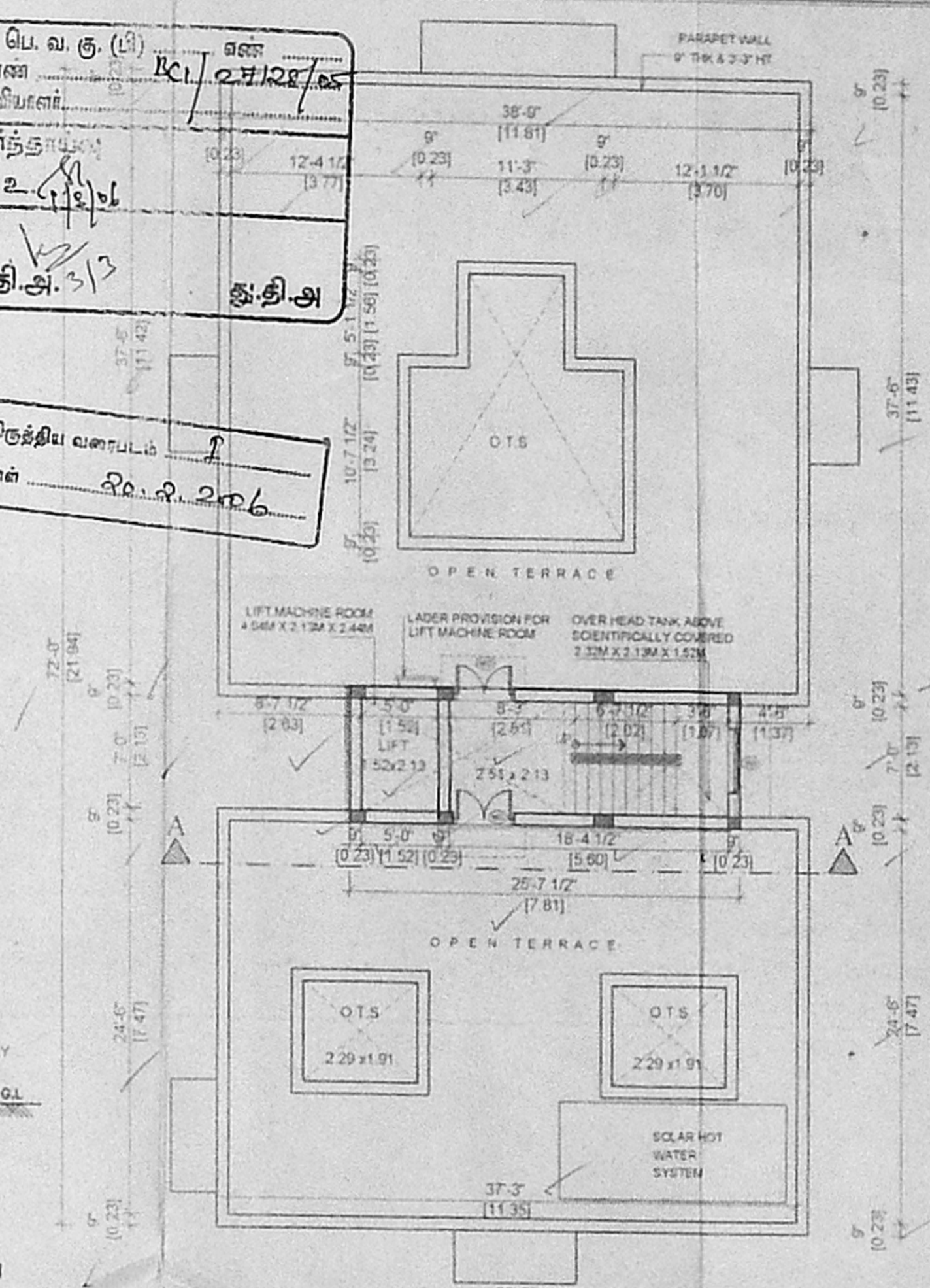

PLAN SHOWING THE PROPOSED CONSTRUCTION OF RESIDENTIAL BUILDING AT BLOCK NO-18, P.T RAJAN SALAI, K.K NAGAR, CHENNAI-600078, KODAMBAKKAM DIVISION, MAMBALAM, MAMBALAM-GUINDY TALUK, T.S NO-394/1 PART, 56/1PART, KODAMBAKKAM K.K NAGAR SCHEME, DIVISION-130, ZONE-9

- SPECIFICATIONS**
- R.C.C COLUMN FOOTING AND PILES IN FOUNDATION
 - COLUMNS AND PILES ARE CONNECTED BY PLINTH BEAMS
 - MOSAIC FLOORING / SPARTAX FLOORING
 - BRICK WORK IN BASEMENT AND SUPER STRUCTURE IN CM 1:5
 - WALLS ARE PLASTERED BY CEMENT PLASTER
 - JOINERY WORK IN TEAK AND COUNTRY WOOD
 - LINTEL OVER OPENING
 - ROOF COVERED BY R.C.C SLAB
 - ALL R.C.C WORK IN CEMENT CONCRETE 1:2:4
 - WEATHERING COURSE LAID WITH PROPER SLOPE OVER R.C SLAB

SCHEDULE OF JOINERY

MD	MAIN DOOR	1.06 X 2.13
D1	DOOR	0.91 X 2.13
D2	DOOR	0.76 X 2.13
FD	FRENCH DOOR	1.83 X 2.13
W1	WINDOW	1.83 X 1.37
W2	WINDOW	1.22 X 1.37
W3	WINDOW	0.61 X 1.37
KW	WINDOW	1.22 X 1.37
V1	VENTILATOR	0.81 X 0.51

AREA STATEMENT

	SFT	SQ.M
PLOT AREA	7017.02	652.14
STILT FLOOR (staircase & lift area)	217.80	20.24
FIRST FLOOR AREA	2548.09	236.72
SECOND FLOOR AREA	2548.09	236.72
THIRD FLOOR AREA	2548.09	236.72
FOURTH FLOOR AREA	2548.09	236.72
TOTAL AREA	10410.17	967.12
PLOT COVERAGE	36.31%	
F.S.I	1.48	

COLOUR INDEX

PROPOSED	
BOUNDARY	
ROAD	

SCALE:- 1" = 8'-0" (1:100)

OWNER -

For SANTHA ENTRAS DEVELOPMENTS AND ENGINEERING STRUCTURES PVT. LTD.

R. Ramakrishnan
Managing Director

LICENSED SURVEYOR

W. K. Sellvam
ER. K. SELVAM,
BE, (Civ), AMIE, C.Eng(I), FIV,
CHARTERED ENGINEER & APPROVED VALUER,
CLASS-I LICENSED SURVEYOR,
Reg No: 600/2005-2006,
DOCR No: 11/206 11th BLOCK
MOGAPPAI EAST, CHENNAI-600 037
(NEAR. MGR ADARSH SCHOOL)
PHONE No: 26522050, 2652050
FLL No: 9841282050